

SEE DW-3

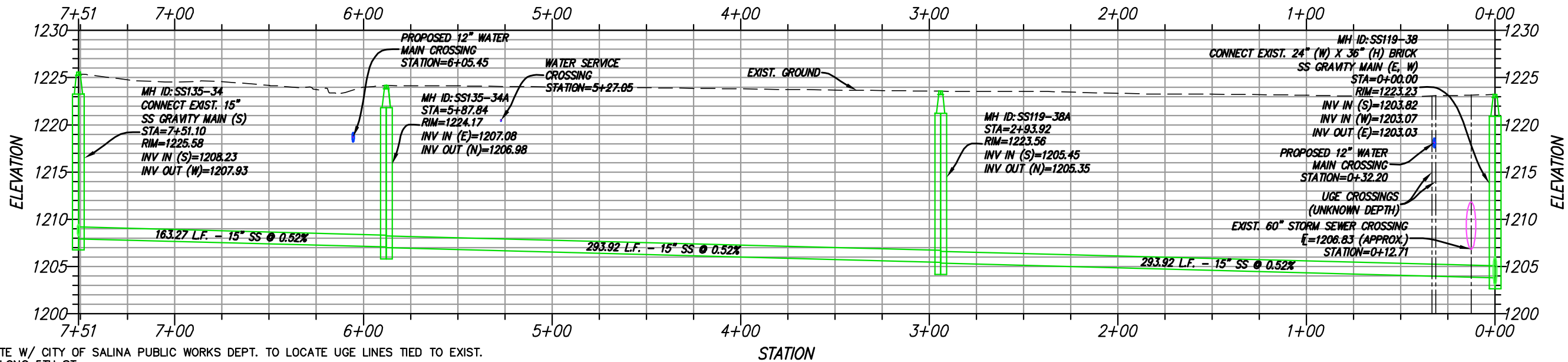

- NOTE:**
- COORDINATE W/ CITY OF SALINA PUBLIC WORKS DEPT. TO LOCATE UGE LINES TIED TO EXIST. LIGHT POLES ALONG 5TH ST.
 - PROPOSED 12" WATER MAIN TO BE CONSTRUCTED PRIOR TO PROPOSED 15" SS GRAVITY MAIN.
 - FIGURE 1 - COORDINATE W/ LOCAL BUSINESSES & PERFORM SHUTDOWN OUTSIDE OF NORMAL BUSINESS HOURS.
 - COORDINATE LOCATION OF PROPOSED FIRE HYDRANTS WITH ENGINEER PRIOR TO CONSTRUCTION.
 - CONTRACTOR TO CONFIRM MANHOLE TIE-IN ELEV. PRIOR TO CONSTRUCTION.
 - TO ABANDON EXIST. 15" SS GRAVITY MAIN, CUT A MIN. OF 12" CLEAR OF THE MH, FILL MAIN WITH FLOWABLE FILL, & PLUG WITH A MIN. OF 6" OF PORTLAND CEMENT CONCRETE (ALL CUTS).
 - CONTACT ENGINEER PRIOR TO REPLACING ANY CURB & GUTTER. DEPENDANT ON FIELDHOUSE DESIGN.

5TH ST (IRON AVE TO ASH ST)

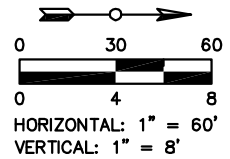

CITY OF SALINA, 300 W ASH, SALINA, KANSAS
PUBLIC WORKS - ENGINEERING - UTILITIES

FIELD HOUSE PROJECT
P & P - 5TH ST (IRON AVE TO ASH ST)

PROJ NO: 53077 DATE: Dec 2015 SHEET: DW-2

FILENAME: Fieldhouse_Project_UTILITY_Rebation_10_13_2015.dwg BY: NDA