

Construct Sanitary Sewer Manhole #3  
 Continue 10" PVC Main Line Southeast for 113.07 L.F. @ 0.50% grade. Begin 8" PVC Lateral Line North for 377.88 L.F. @ 0.40% grade (Yeager)  
 Top=1243.50  
 FL In (N)=1226.20  
 FL In (W)=1225.59  
 FL Out (SE)=1225.57  
 FL Centerline=1225.58  
 N=165,986.35 E=1,419,394.94

Construct Sanitary Sewer Manhole #2  
 Continue 10" PVC Main Line South for 280.00 L.F. @ 1.42% grade. Top=1242.50  
 FL In (NW)=1225.01  
 FL Out (S)=1224.99  
 FL Centerline=1225.00  
 N=165,912.05 E=1,419,480.15

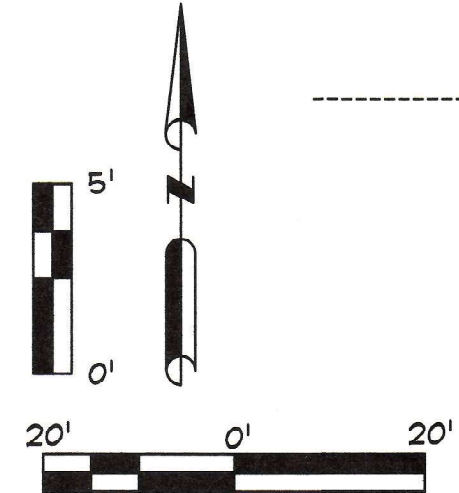

Hor. Scale: 1" = 20'  
 Vert. Scale: 1" = 5'

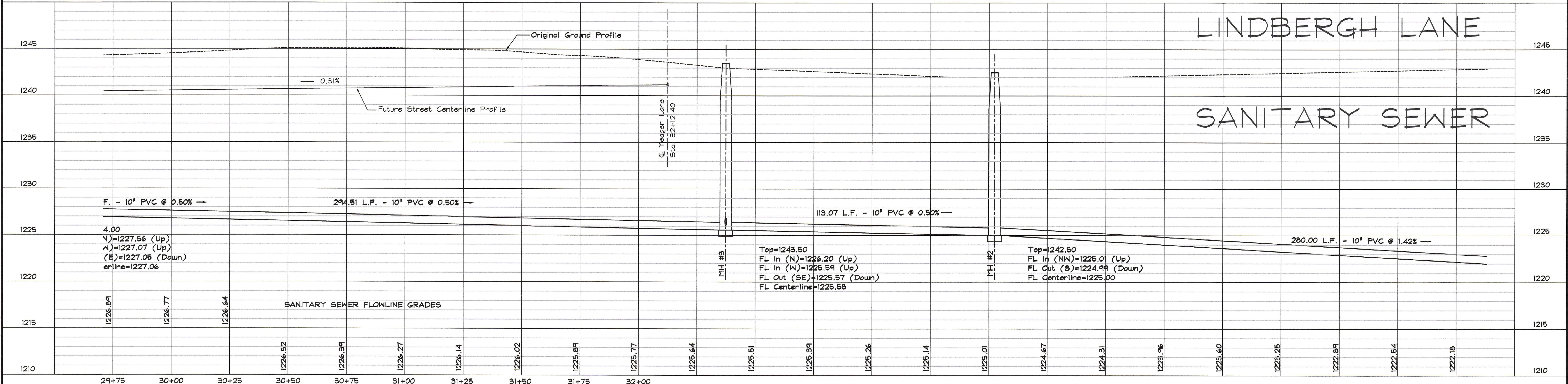

LINDBERGH - WATER & SEWER