

SCALE:
 PLAN: 1"=20'
 PROFILE: 1"=20' HORIZ.
 1"=5' VERT.

SEPARATION OF WATER MAINS AND SANITARY SEWERS:

1. A MINIMUM HORIZONTAL DISTANCE OF 10 FEET SHALL BE MAINTAINED BETWEEN WATER (MAINS AND SERVICE) AND SANITARY SEWER (MAINS AND SERVICE) LINES.
2. WHERE A WATER MAIN MUST CROSS A SEWER LINE, MAINTAIN 2 FEET VERTICAL SEPARATION WITH THE WATER MAIN ABOVE THE SEWER.
3. BUILDERS TO MAINTAIN MINIMUM 10' SEPARATION FROM THE OUTSIDE EDGE OF SANITARY SEWER MANHOLES TO THE OUTSIDE EDGE OF WATER SERVICE LINES WHEN RUNNING SERVICE LINES TO HOUSE.

GENERAL NOTES:

1. ALL SANITARY SEWER SERVICE LINE WILL BE AT A MIN 2% GRADE.
2. ALL NORTHING AND EASTING WAS TAKEN FROM CENTER OF STRUCTURE. REFERENCE DETAIL FOR ACTUAL LID LOCATION.

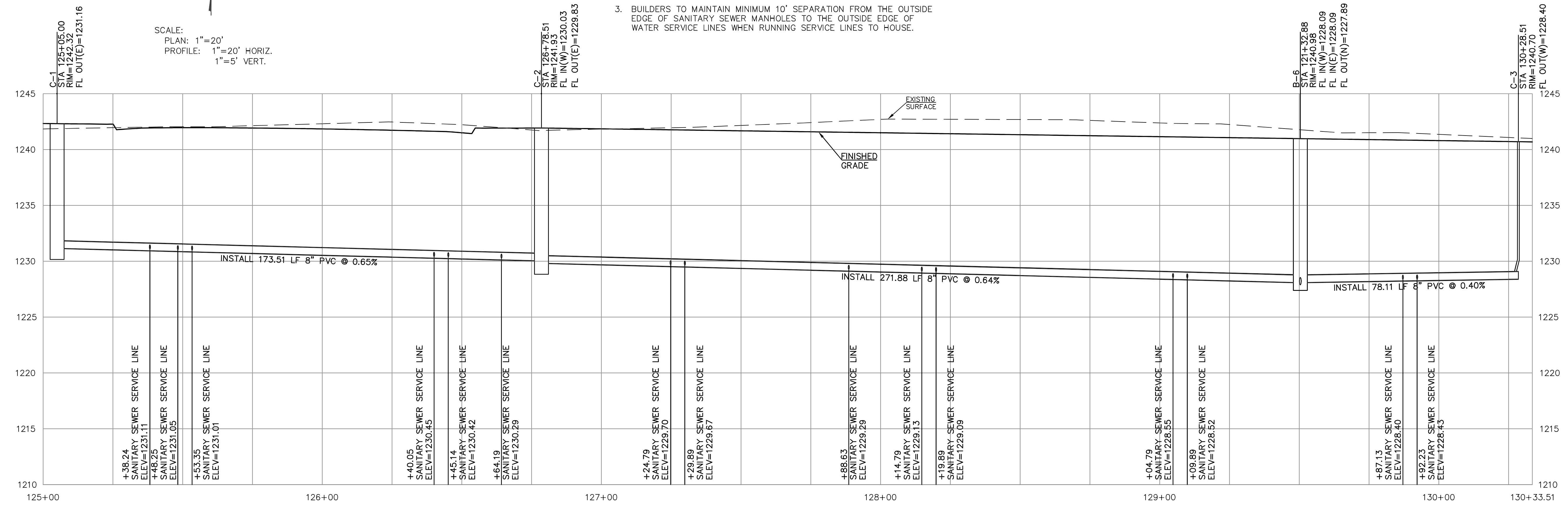

PROJ. NO.	E21D2859
DESIGNER	JMO
DRAWN BY	TDA
CFN	2859SPP
SHEET	31
REV	0

STONE LAKE ADDITION - PHASE 3C
CRYSTAL LAKE DRIVE & SHORELINE DRIVE
SALINA, KANSAS

OFFICE CHECK
SANITARY SEWER LINE 'C' - PLAN & PROFILE

JUSTIN M. OWENS
 ENGINEER
 KS # 20933

742 DUVALL AVENUE
 SALINA, KANSAS 67401
 PH. (785) 822-3411
 www.kawvalley.com

KAW VALLEY ENGINEERING
 KAW VALLEY ENGINEERING, INC. IS AUTHORIZED TO OFFER ENGINEERING SERVICES BY KANSAS STATE CERTIFICATE OF AUTHORIZATION # E-113. EXPIRES 12/31/22

REV	DATE	DESCRIPTION
0	01/11/22	INITIAL ISSUE
JMO	TDA	DSN
JMO	JMO	CHK

THIS DRAWING SHALL NOT BE UTILIZED BY ANY PERSON, FIRM, OR CORPORATION IN WHOLE OR IN PART WITHOUT THE SPECIFIC PERMISSION OF KAW VALLEY ENGINEERING, INC.