

SCALE:  
 PLAN: 1"=20'  
 PROFILE: 1"=5' VERT.

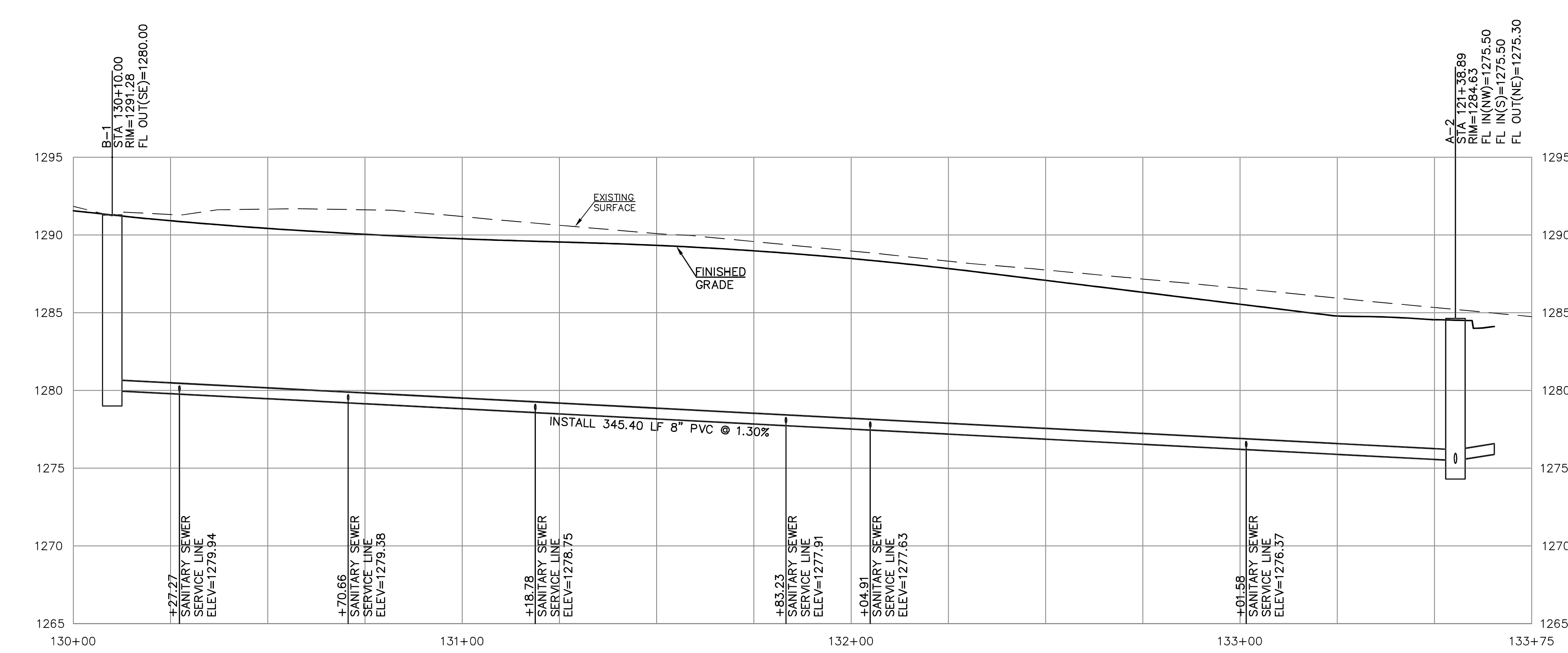

SANITARY SEWER LINE 'B'

- SEPARATION OF WATER MAINS AND SANITARY SEWERS:**
1. A MINIMUM HORIZONTAL DISTANCE OF 10 FEET SHALL BE MAINTAINED BETWEEN WATER (MAINS AND SERVICE) AND SANITARY SEWER (MAINS AND SERVICE) LINES. AT POINT WHERE SEWERS CROSS WATER MAINS, THE SEWER SHALL BE CONSTRUCTED OF CAST IRON, PLASTIC PIPE WITH NON-JOINTED PLASTIC PIPE, OR PIPE ENCASED IN CONCRETE FOR A DISTANCE OF 10 FEET EACH SIDE OF THE CROSSING AS MEASURED FROM THE OUTSIDE DIAMETER OF THE SEWER LINE (EDGE-TO-EDGE), NOT ITS CENTERLINE, UNLESS THE WATER MAIN IS AT LEAST 2 FEET ABOVE THE SEWER.
  2. WHERE A WATER MAIN MUST CROSS A SEWER LINE, MAINTAIN 2 FEET VERTICAL SEPARATION WITH THE WATER MAIN ABOVE THE SEWER.
  3. BUILDERS TO MAINTAIN MINIMUM 10' SEPARATION FROM THE OUTSIDE EDGE OF SANITARY SEWER MANHOLES TO THE OUTSIDE EDGE OF WATER SERVICE LINES WHEN RUNNING SERVICE LINES TO HOUSE.
  4. ALL SANITARY SEWER SERVICE LINE WILL BE AT A MIN 2% GRADE.
  5. ALL NORTHING AND EASTING WAS TAKEN FROM CENTER OF STRUCTURE. REFERENCE DETAIL FOR ACTUAL LID LOCATION.

PROJ. NO.	E21D2818
DESIGNER	JMO
DRAWN BY	TDA
CFN	2818SPP
SHEET	18
REV	0

REV	0	10/28/21	INITIAL ISSUE	DSN	DWN	CHK
REV			DATE	DESCRIPTION		

**MAGNOLIA HILLS ESTATES ADD. NO. 2**  
 HUNTWOOD DRIVE & KASYN LANE  
 SALINA, KANSAS 67401

**PHASE II**  
 SANITARY SEWER LINE 'B' - PLAN & PROFILE

JUSTIN M. OWENS  
 ENGINEER  
 KS # 20933

742 DUVALL AVENUE  
 SALINA, KANSAS 67401  
 PH. (785) 823-3411  
 www.kawvalley.com

**KAW VALLEY ENGINEERING**  
 KAW VALLEY ENGINEERING, INC. IS AUTHORIZED TO OFFER ENGINEERING SERVICES BY KANSAS STATE CERTIFICATE OF AUTHORIZATION # E-113. EXPIRES 12/31/22

THIS DRAWING SHALL NOT BE UTILIZED BY ANY PERSON, FIRM, OR CORPORATION IN WHOLE OR IN PART WITHOUT THE SPECIFIC PERMISSION OF KAW VALLEY ENGINEERING, INC.