

City of Salina, Kansas
Salina Municipal Golf Course
Sanitary Sewer Service Line
Project 13-2957

DATE	REVISIONS

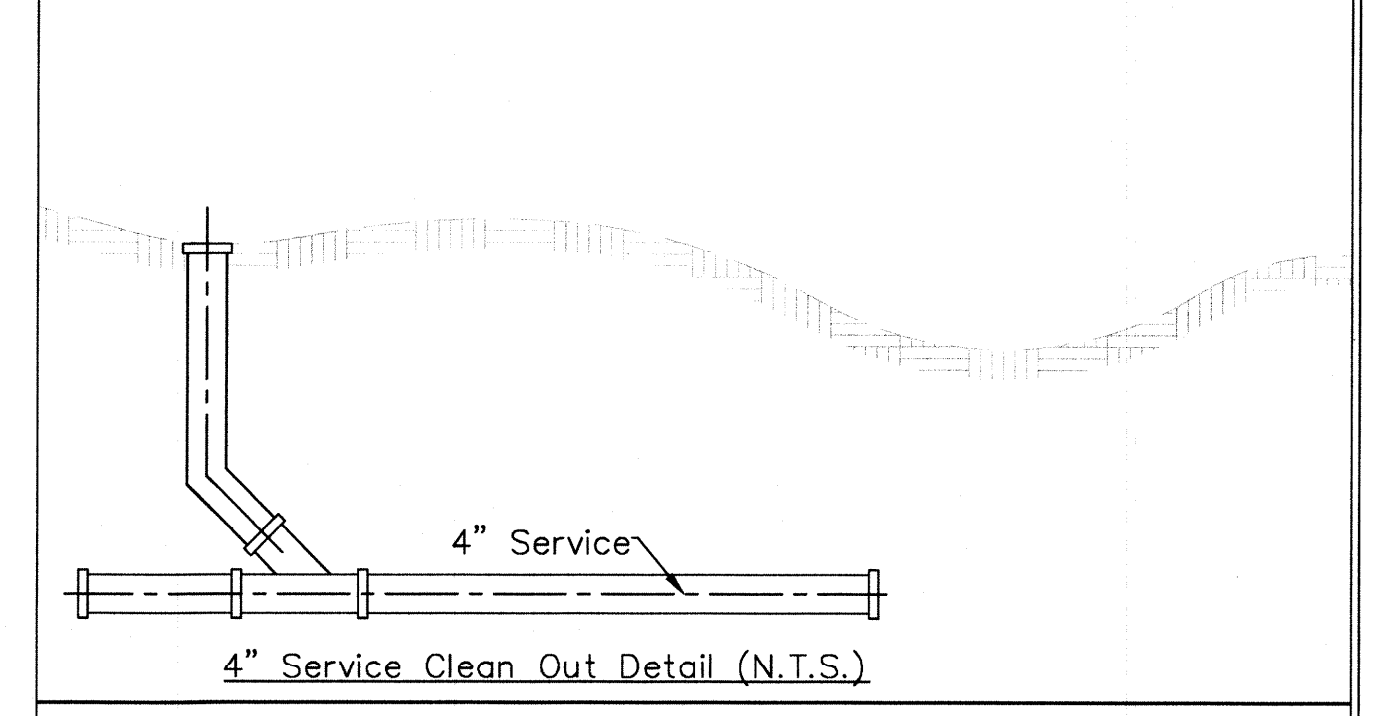
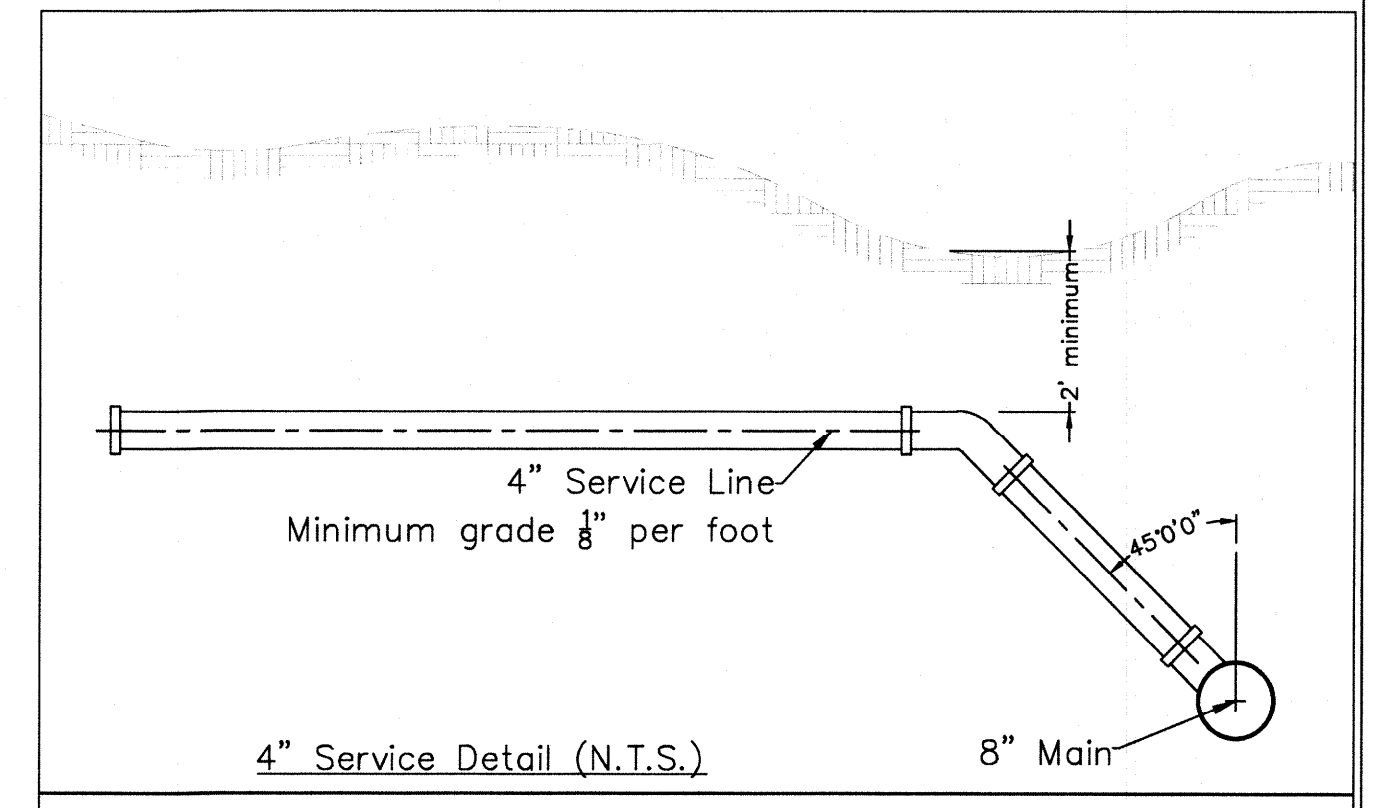
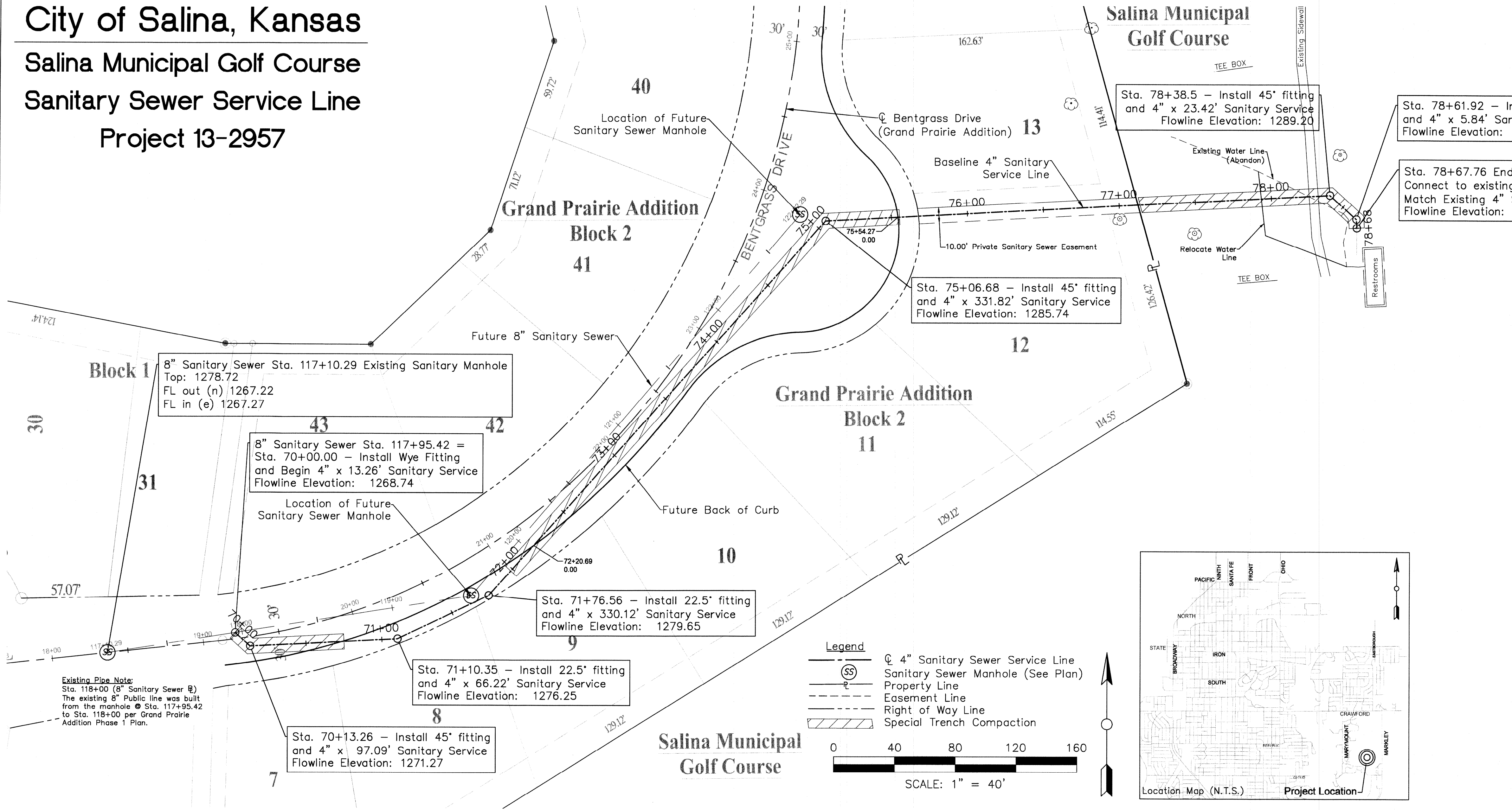

General Note:

- Maintain minimum of 2' of cover above top of service line.
- Install clean out every 100' and at each turn of 135' or more.
- UPC 701.1 Drainage piping shall be cast-iron, galvanized steel, galvanized wrought iron, lead, copper, brass, Stainless Steel 304 or 316L, Schedule 40 ABS DWV, Schedule 40 PVC DWV, extra-strength vitrified clay pipe, or other approved materials having a smooth and uniform bore.
- UPC 701.2 Drainage fittings shall be of cast-iron, malleable iron, lead, brass, copper, ABS, PVC, vitrified clay, stainless steel 304 and 316L (304 shall not be installed underground and shall be kept at least 6 inches (152 mm) aboveground), or other approved materials having a smooth interior waterway of the same diameter as the piping served, and all such fittings shall be compatible with type of pipe used.

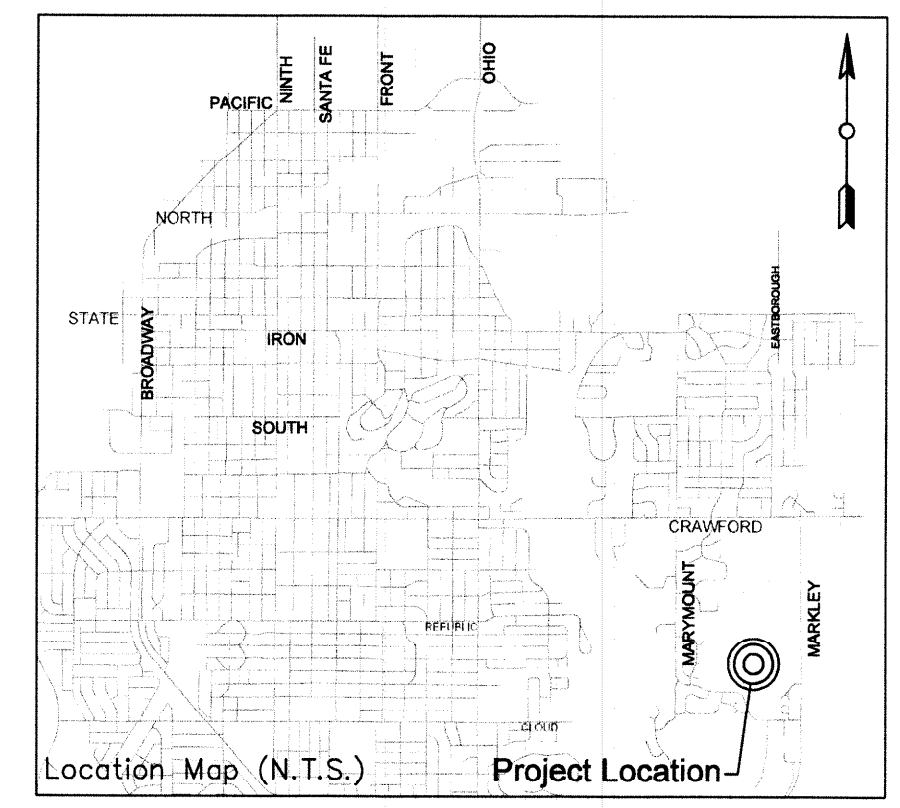

W. Wayne E. Nelson
25 February 2013