

Photo: 2015/10/26 10:57 AM

Plot Driver: I:\S:\N\PROJECTS\CADD\STATION\BENTLEY\SYSTEM\PILOTDRV\pdf\DWG.dgn

Drawing Name: I:\S\N\PROJECTS\CADD\STATION\BENTLEY\SYSTEM\PILOTDRV\pdf\DWG.dgn



BM NO. 11 EL. 1308.39  
 CHISLED "+" CUT IN NE BONNET BOLT ON FH.  
 TIES:  
 1. NORTH END GUARD RAIL 39.1' S.E.  
 2. EAST END OF GUARD RAIL 73.2' E.S.E.  
 3. S.W. COR. PORP. PIN 5/8" RBR 89.0' S.S.W.

N. 173180.395  
 E. 1435215.345



**LOCHNER**  
 1823 S. Ohio Street | Salina, Kansas 67401-3713  
 P 785.827.3603 | F 785.827.3029

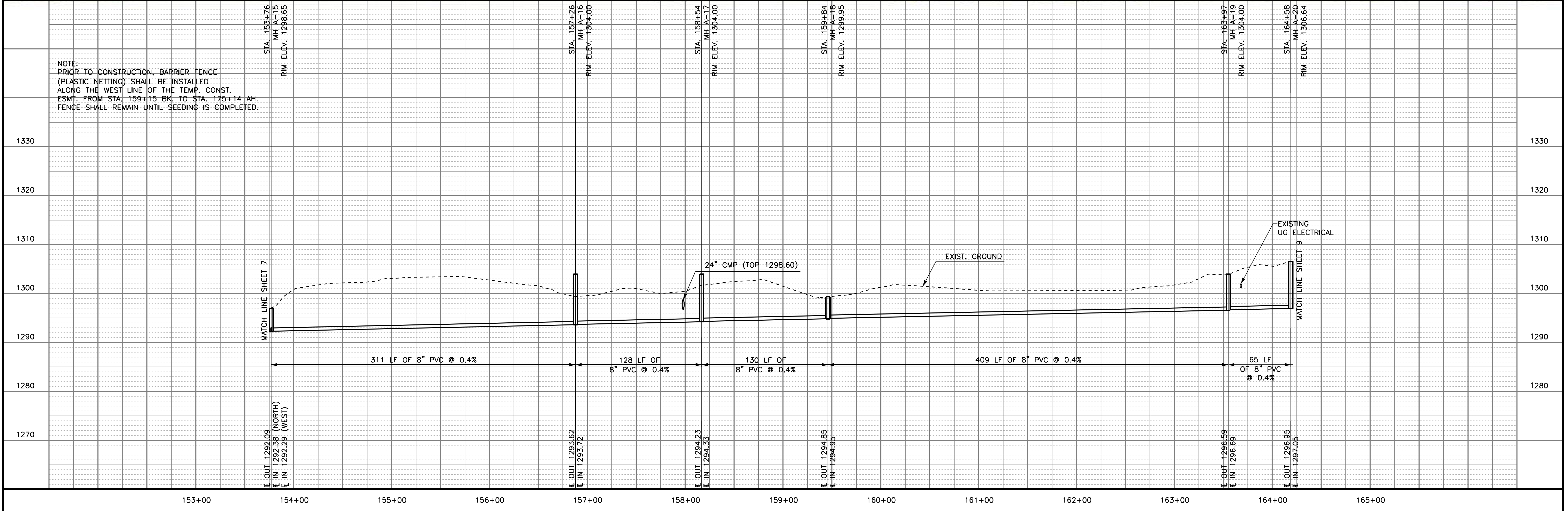
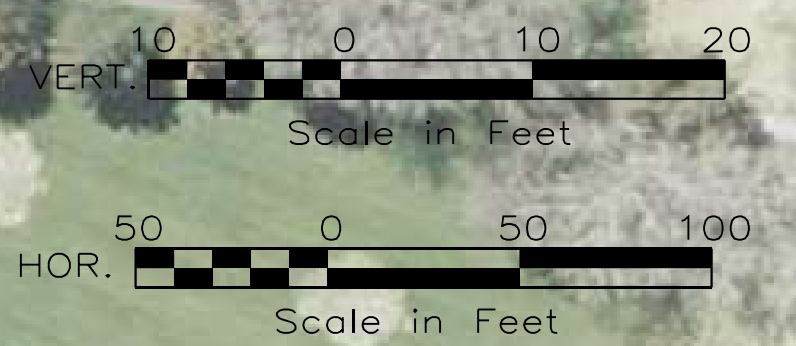

NOTE:  
 PRIOR TO CONSTRUCTION, BARRIER FENCE  
 (PLASTIC NETTING) SHALL BE INSTALLED  
 ALONG THE WEST LINE OF THE TEMP. CONST.  
 ESMT. FROM STA. 159+15 BK. TO STA. 175+14 AH.  
 FENCE SHALL REMAIN UNTIL SEEDING IS COMPLETED.

**CITY OF SALINA**  
**MARKLEY/MAGNOLIA SEWER SYSTEM**  
**PLAN & PROFILE**

PROJECT NO. 2007-455  
 DRAWN BY DLK  
 CHECKED BY CRL  
 DESIGNED BY CRL  
 REVISIONS

ISSUE DATE 10-29-2015

PLAN & PROFILE

**8**  
 SHEET 8 OF 17