

LEGEND

EXIST.	NEW	DESCRIPTION
—S—	—S—	SANITARY SEWER LINE
—G—	—G—	GAS LINE
—W—	—W—	WATER LINE
⊙	⊙	GAS METER
○	○	MANHOLE
⊕	⊕	WATER VALVE
⊕	⊕	FIRE HYDRANT-2 WAY
⊕	⊕	POWER POLE
⊕	⊕	TELEPHONE POLE
—	—	GUY & ANCHOR
—	—	RIP-RAP
—	—	LEVEE
—x—	—x—	BARBED WIRE FENCE
—o—	—o—	CHAIN LINK FENCE
—	—	BOARD FENCE
—	—	TREE
—	—	HEDGE
—	—	STUMP
—	—	TEST HOLE
—	—	PVMT. REMOVAL & RECONSTRUCTION
—	—	BUILDING
—	—	RAILROAD TRACKS
—	—	HIGHWAY LIGHTS

Test Hole 14A
 0-7.5' Brown Silty Clay
 7.5-9' Brown Silty Sand (Fine)
 9-17' Brown Silty Clay (Stiff)
 Water Elev. 07.59 28 Mar. 62

TBM - "x" cut in concrete top of East end of Northeast wingwall of East Crawford Street and Smoky River Bridge. Elev. 1241.226

TBM - On fire hydrant; "o" cut in top of North shoulder of East cap bolt depression on Northeast corner of Intersection of Wilbre Street & Jaran Street. Elev. 1228.211

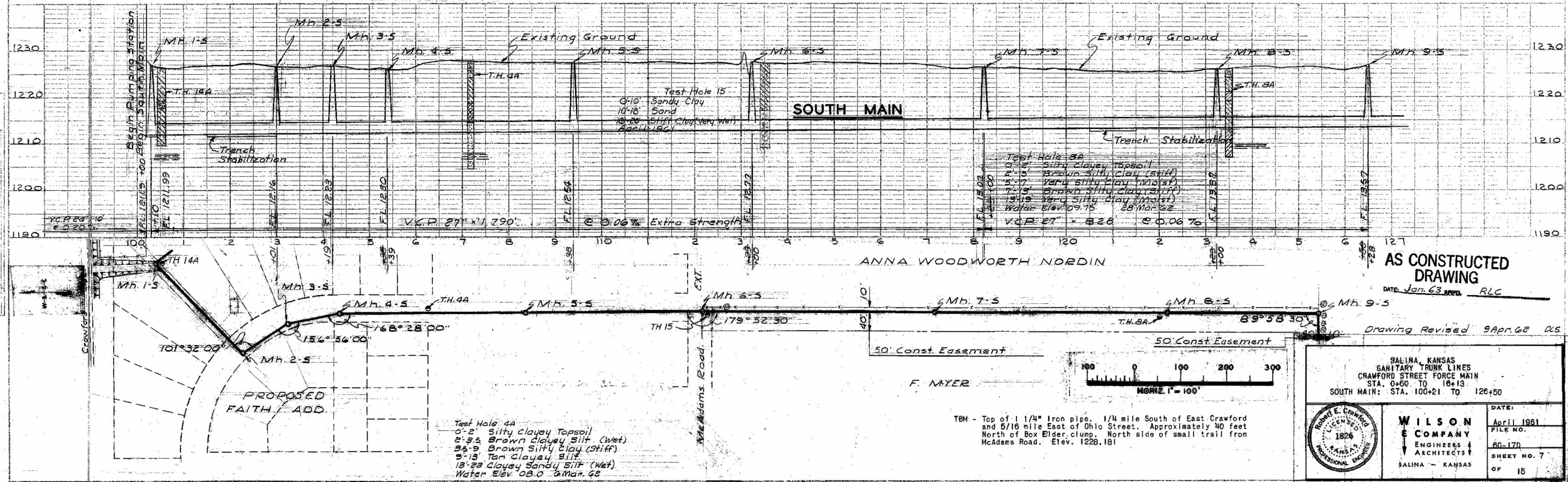

AS CONSTRUCTED DRAWING

DATE Jan. 63 APPD. RLC

Drawing Revised 9Apr. 68 DS

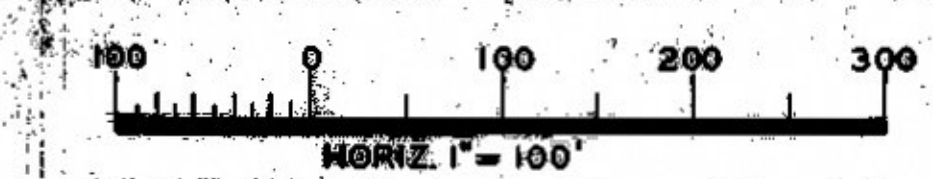

Test Hole 4A
 0-2' Silty clayey topsoil
 2-5.5' Brown clayey silt (wet)
 5.5-9' Brown Silty Clay (Stiff)
 9-13' Tan Clayey silt
 13-23' Clayey Sandy silt (Wet)
 Water Elev. 08.0 2 Mar. 62

TBM - Top of 1 1/4" Iron pipe, 1/4 mile South of East Crawford and 5/16 mile East of Ohio Street. Approximately 40 feet North of Box Elder clump, North side of small trail from McAdams Road. Elev. 1228.181

SALINA, KANSAS
 SANITARY TRUNK LINES
 CRAWFORD STREET FORCE MAIN
 STA. 0+00 TO 16+13
 SOUTH MAIN: STA. 100+21 TO 126+50

WILSON COMPANY
 ENGINEERS & ARCHITECTS
 SALINA - KANSAS

DATE: April 1961
 FILE NO. 60-17D
 SHEET NO. 7 OF 15