

NO. 10	DESIGNED BY	W. H. WATSON
NO. 11	CHECKED BY	W. H. WATSON
NO. 12	APPROVED BY	W. H. WATSON
NO. 13	DATE	1-15-52

NO. 14	DESIGNED BY	W. H. WATSON
NO. 15	CHECKED BY	W. H. WATSON
NO. 16	APPROVED BY	W. H. WATSON
NO. 17	DATE	1-15-52

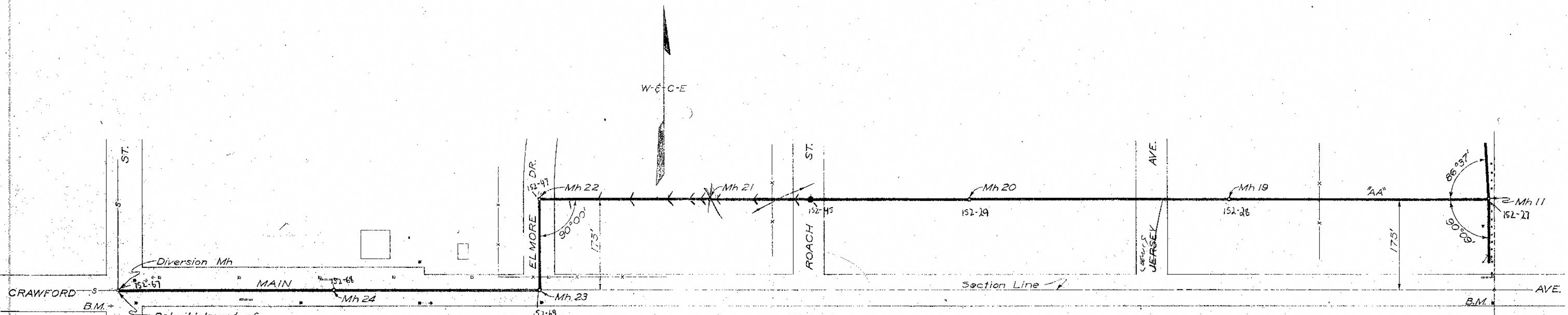
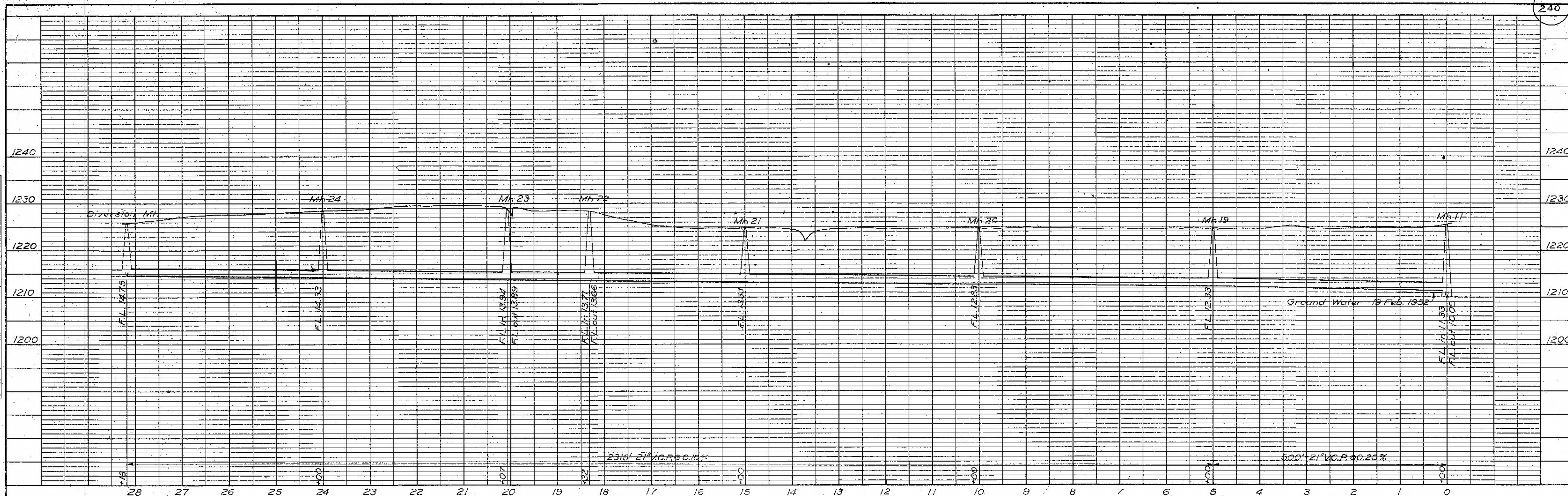

BENCH MARKS
 70" in OPEN on Fire Hydrant at S.W. Cor. Front & Crawford
 Elevation 1227.38
 Spike in Power Pole S. of Crawford & Ohio Avenue
 Centerline Extension. Elevation 1225.78

- LEGEND**
- Gas
 - Water
 - Telephone Cable
 - Sanitary Sewer
 - Storm Sewer
 - Existing Manhole
 - New Sanitary Sewer & Manhole
 - Fire Hydrant
 - Barbed Wire Fence
 - Drainage Ditch
 - Existing Curb & Gutter
 - Section Line
 - Hedge
 - Existing Culvert
 - Trees
 - B.M. Bench Mark
 - Power Pole
 - Telephone Pole
 - Corner Stone
 - Inlet
 - Anchor
 - Test Hole
 - S; Silt
 - S Sand
 - C Clay

SCALE
 Plan: 1"=100'
 Profile: 1"=100' Horiz.
 1"=10' Vert.



SALINA KANSAS
SANITARY SEWER EXTENSIONS
 MAIN "AA" - STA. 0+00 TO STA. 28+18
 SCALE AS NOTED
WILSON AND COMPANY
 ENGINEERS
 SALINA, KANSAS
 1952