

PROJECT: SALINA, KANSAS
 SHEET: 229
 DATE: APR 14 1958
 DRAWN BY: W. J. K.
 CHECKED BY: R. S.
 APPROVED BY: W. J. K.

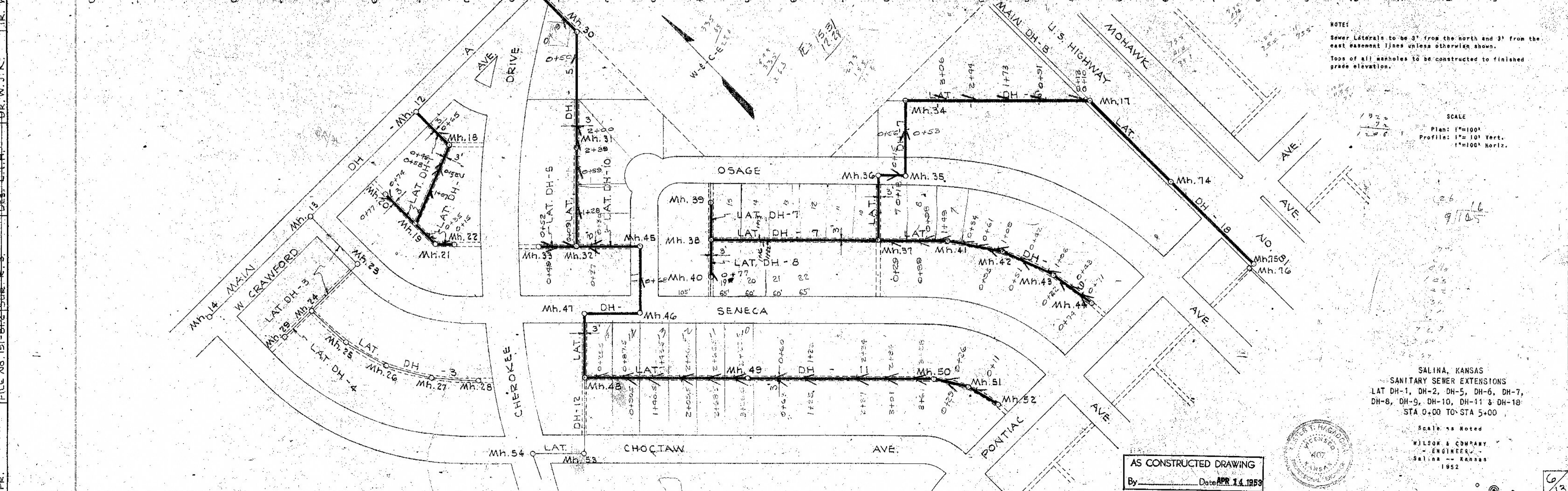
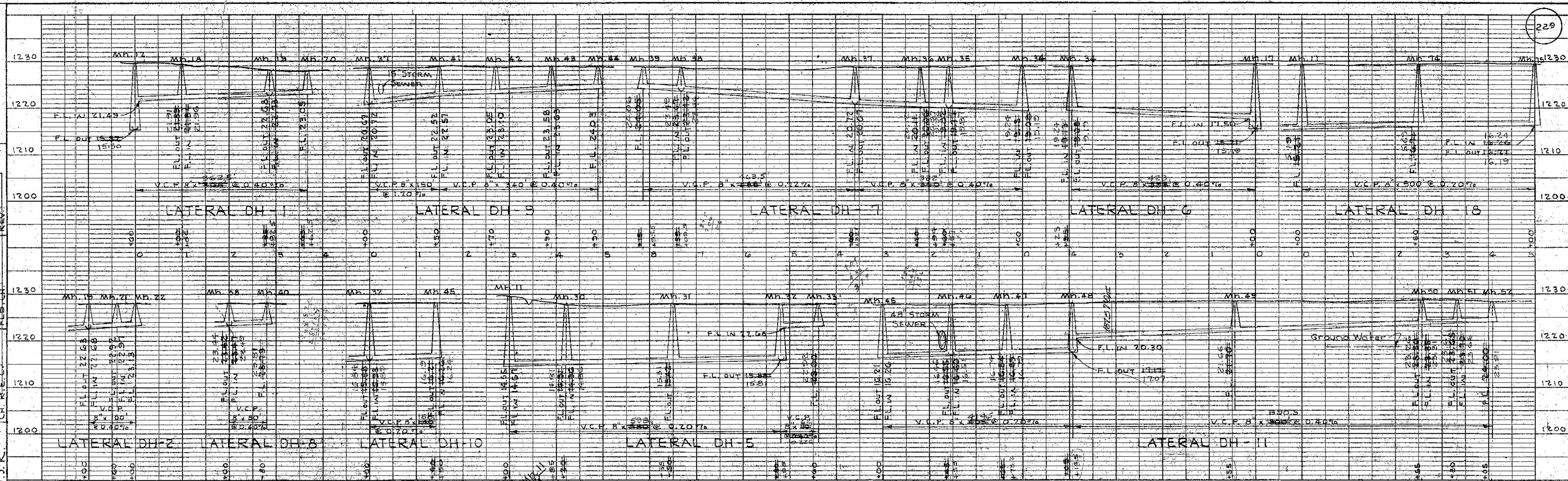

NOTES:
 Sewer Laterals to be 3' from the north and 3' from the east easement lines unless otherwise shown.
 Tops of all manholes to be constructed to finished grade elevation.

SCALE:
 Plan: 1"=100'
 Profile: 1"=10' Vert.
 1"=100' Horiz.

SALINA, KANSAS
 SANITARY SEWER EXTENSIONS
 LAT. DH-1, DH-2, DH-5, DH-6, DH-7,
 DH-8, DH-9, DH-10, DH-11 & DH-18
 STA 0+00 TO STA 5+00

AS CONSTRUCTED DRAWING
 By: _____ Date: APR 14 1958

