

PLAN
 PROJECT: SEWER CONSTRUCTION
 SHEET: 155
 DATE: 2/30/38

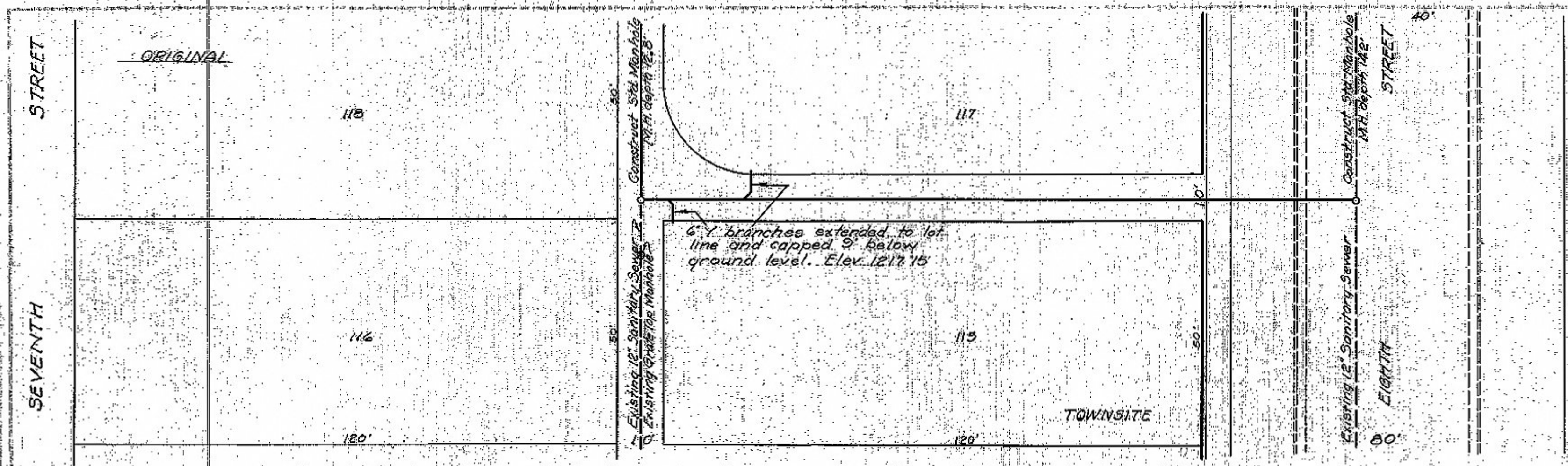

NOTE
 Sanitary sewer construction shall be in accordance with Standard Spec. No. 14 for Pipe Sewer of the City of Salina, Kansas. All joints shall be made with hot poured asphaltic joint material previously approved by the City Engineer.

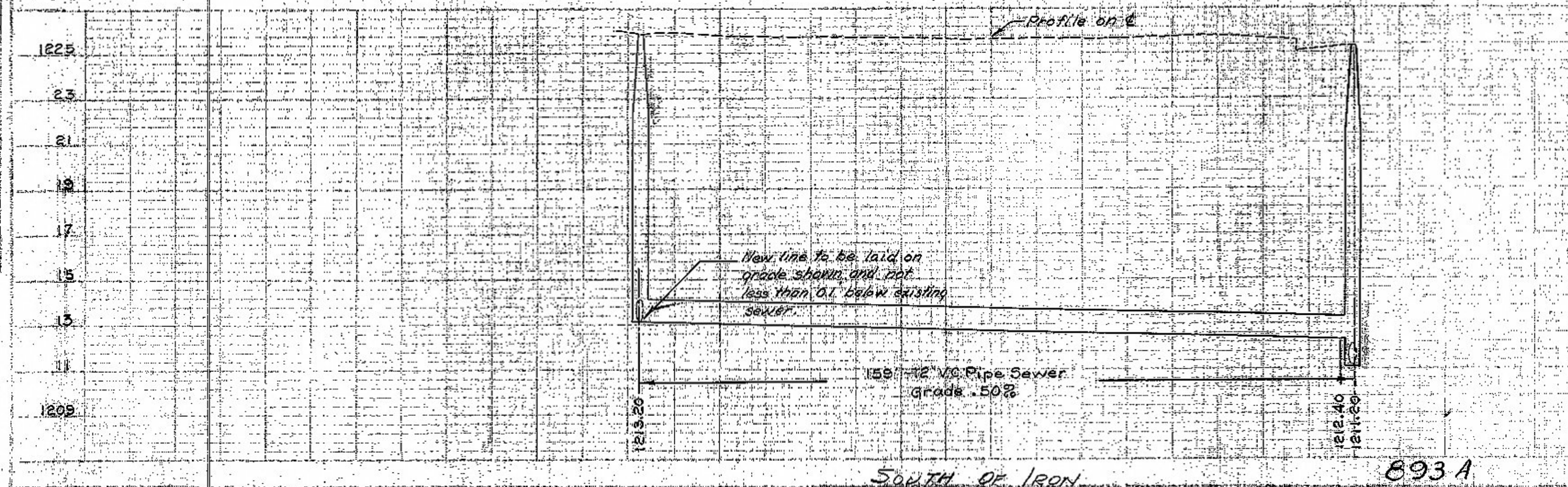

PROFILES
 PROJECT: SEWER CONSTRUCTION
 SHEET: 155
 DATE: 2/30/38

