

DATE: _____
 BY: _____
 SUPERVISOR: _____
 PLOTTED: _____
 NOTE BOOK: _____
 NO. OF WAY CHECKED: _____
 NO.:

FILED
 SEP 29 1930
 CHAS. E. BANKS
 CIVIL ENGINEER

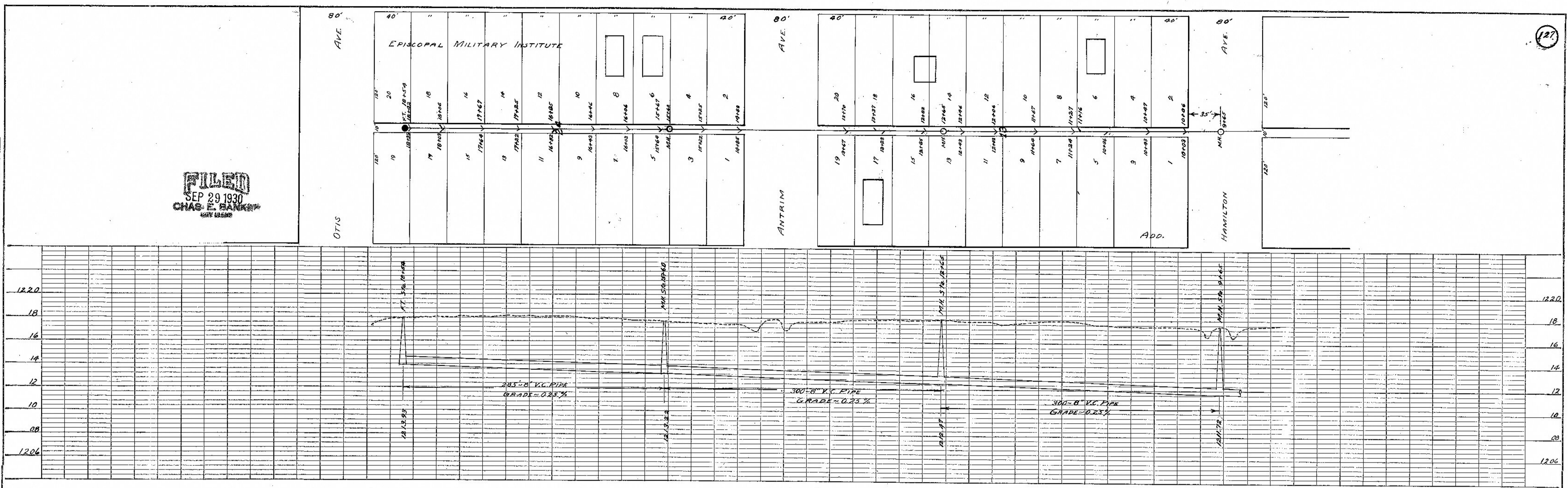

DATE: 9-29-30
 BY: L.M. Smeal
 SUPERVISOR: _____
 PLOTTED: _____
 NOTE BOOK: _____
 NO. OF WAY CHECKED: _____
 NO.:

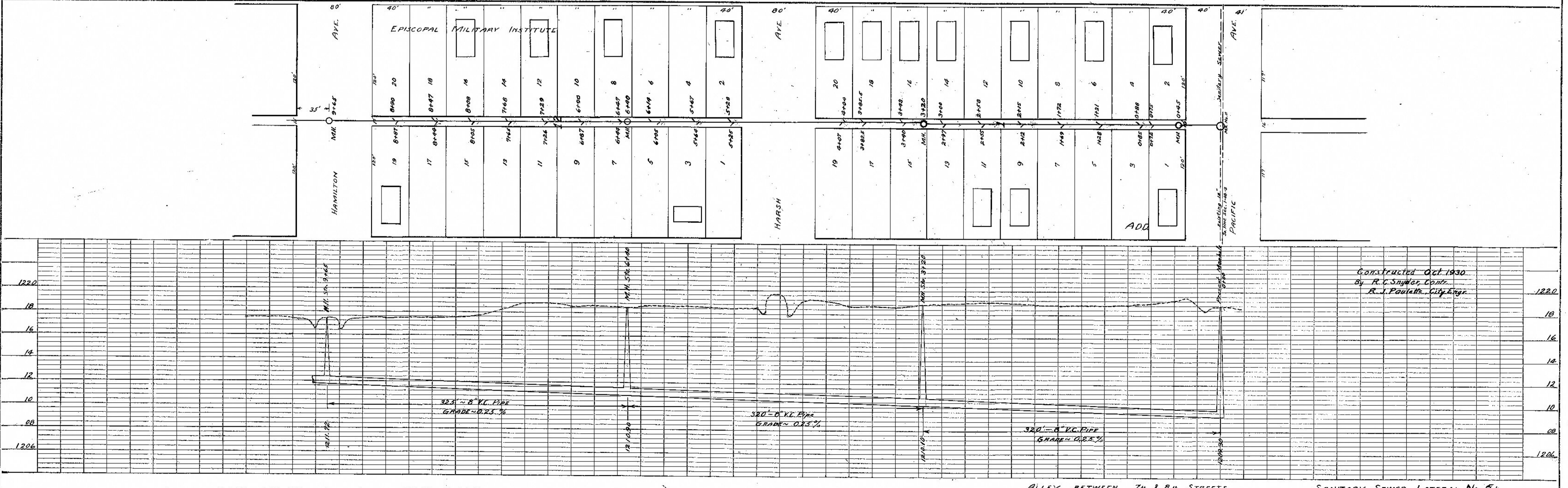

Constructed Oct 1930
 by R.C. Snyder, Comr.
 R.J. Paulick, City Eng.

ALLEY BETWEEN 7th & 8th STREETS SANITARY SEWER LATERAL No 51